

**MONUMENT RECORD**  
State of Indiana - County of Monroe

**Section:** 26      **Township:** 8 North      **Range:** 1 East      **Corner ID:** SaCr U-19

**Monument Description & Remarks:** 3" Iron Pipe with metal cap found. Survey Sign 4ft A.G. at Pt. (E).

**References On File:** Legal Survey Book 2 page no. 47 survey (1874), & page no. 261-262 survey (1877) on file in Surveyors office; Bledsoe Tapp & Riggert., Inc. survey, U.S.D.A Forest Service (2003), on file in Surveyors office & Recorders office (Inst# 2003003392).

RECOVERY TIE DRAWING  
Field Book 37 Page No. 75

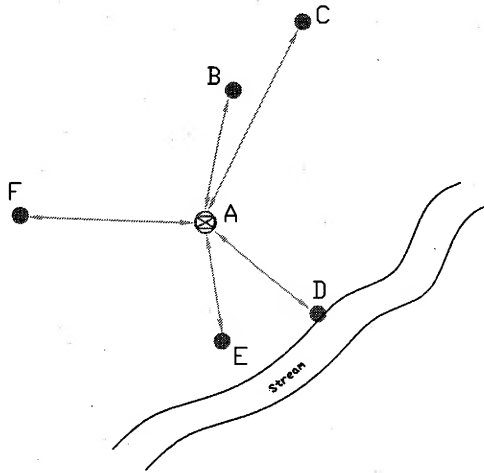
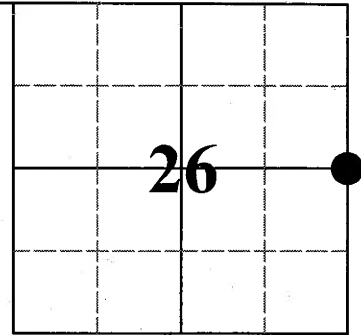

- A - 3" Iron Pipe with cap.
- B - N 49° E 15.83' to nail in Sign on 6" Sugar Maple.
- C - N 40° E 48.32' to 5/8" Rebar with, R.H. LUDWIG, cap.
- D - S 45° E 11.00' to Stream Bank.
- E - S 09° E 11.57' to MAG nail in Survey Sign on 6" Sugar Maple.
- F - S 85° W 19.93' to nail in Sign on 29" White Oak.



Not To Scale  
Compass Bearing Magnetic North

I, Kevin P. Enright, Monroe County Surveyor, hereby certify that this document was prepared under my direction in accordance with the provisions of section 11 of the Indiana Code; and the above data is given under my hand and seal this 7th day of February, 2006.

*Kevin P. Enright*



Administered by the Monroe County Surveyor Review Board

Date: 6/16/2006

# MONUMENT RECORD

STATE OF INDIANA ~ COUNTY OF MONROE

SECTION 28, TOWNSHIP 8 NORTH, RANGE 1 EAST

**MONUMENT DESCRIPTION & REMARKS:** 5/8" REBAR W/LUDWIG CAP 1' ABOVE GRADE MARKING THE NORTHEAST CORNER OF THE SOUTHEAST 1/4 OF SECTION 28.

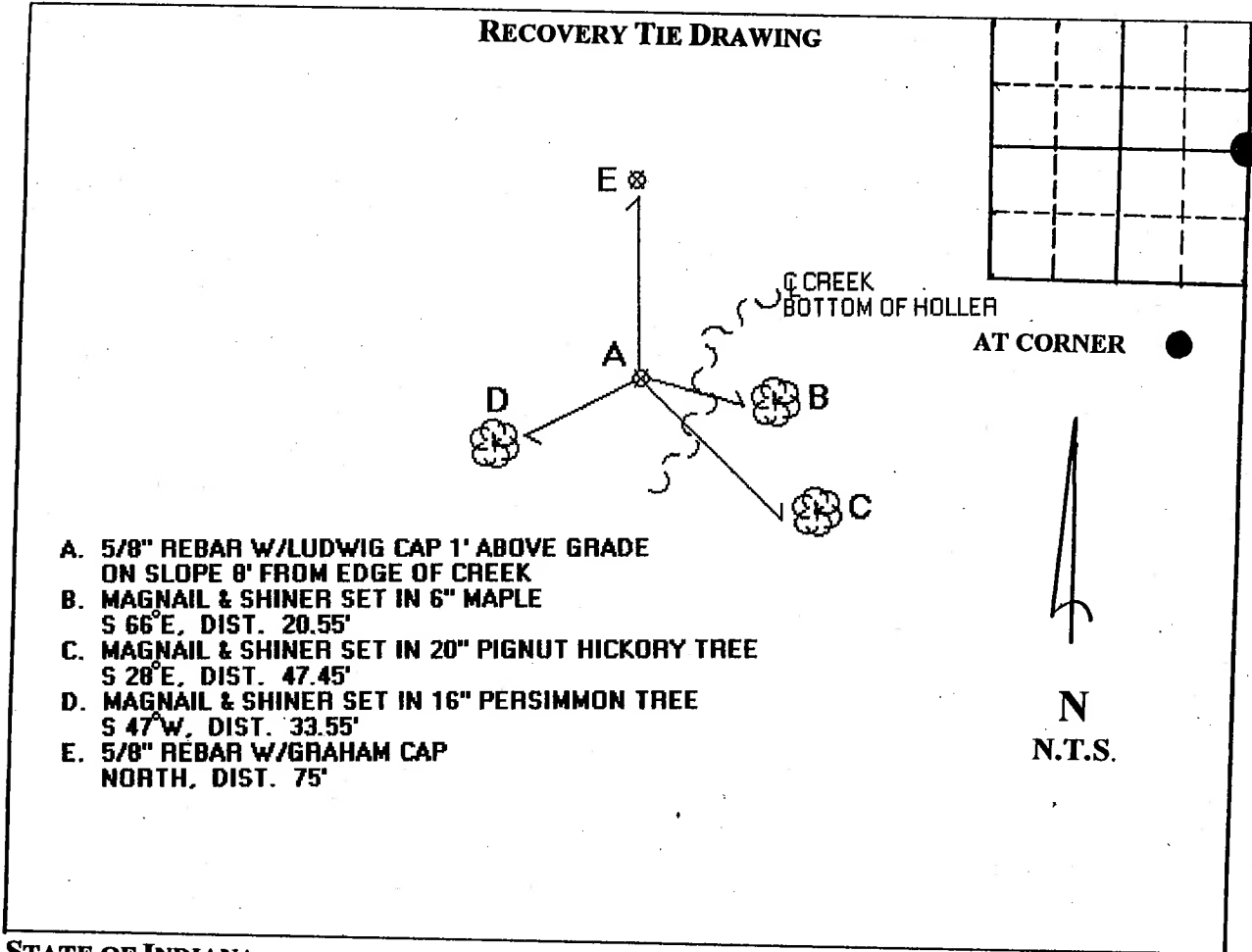

STATE OF INDIANA  
COUNTY OF MONROE

I, STEVEN V. FARKAS, HEREBY CERTIFY THAT THIS DOCUMENT WAS PREPARED UNDER MY DIRECTION IN ACCORDANCE WITH THE PROVISIONS OF SECTION 17-3-64-4 THROUGH 17-3-64-8 OF THE INDIANA CODE, BEING ACTS OF 1965, CHAPTER 319; AND THE ABOVE DATA IS GIVEN UNDER MY HAND AND SEAL  
THIS \_\_\_\_\_ DAY OF \_\_\_\_\_, 200\_\_ A.D.

INDIANA REGISTERED LAND SURVEYOR No. \_\_\_\_\_ OR

UNITED STATES GOVERNMENT AGENCY

TITLE

FIELD BOOK: \_\_\_\_\_

PAGE: \_\_\_\_\_

DRAFT #: 87

165

SaGr U19  
State of Indiana  
Hoosier National Forest  
MONROE

**EXISTING SURVEYS**

Original Government Survey				Original Survey Evidence Found			
Year Surveyed:	1814	By: Arthur Henrie		Date of Search:	Nov, 2002	By: E.D. B.T.	
Original Monument:	wood post			Monument Found:	none		
Species	Diameter	Bearing	Distance	Species	Diameter	Bearing	Distance
Beech	18	S 36 W	10L = 6.6'	none			
"	6	N 30 E	37L = 24.42'				
Subsequent Corner Restoration				Evidence of Subsequent Corner Restoration Found			
Where Filed or Recorded: MONROE County Survey Book 2				Year Searched: By:			
Recorded: NONE				Monument Found:			
Book:	Page:	Date:					
Momment Set:							
Species	Diameter	Bearing	Distance	Species	Diameter	Bearing	Distance

**OTHER EVIDENCE**

Describe corner loc. relative to nearby features & dir. to corner location; note fences, roads, etc.	Sketch of Moniment

**PERPETUATION RECORD**

Monument: Describe new monument set or work done to perpetuate/preserve the existing monument/position.

set 3" cap on aluminum post 4" tall in rockpile  
 set survey boundary post  
 monument is on the NW side of a steep gully  
 fd. 5/8" rebar with LUDWIG cap 10" tall N36-07-34E, 48.29' from corner  
 Jan. 6, 2003

<b>Corner Diagram</b>	<b>Accessories: Describe new BTs &amp; witness objects established to perpetuate existing evidence.</b>		
	6" MAPLE N 37 E, 15.8' to cen. tree, blazed, scribed BT, painted red		
	7" MAPLE S 15 E, 11.8' " " " " " " " "		
	28" OAK S 80 W, 21.5' " " " " " " no red band		
	Corner Recordation:	Certificate Prepared:	E.D.
	Filed and Recorded in County records:	Date:	2003
	Book:	Page:	
Section: 26	Geodetic Coordinates:		Lat./N. 37° 05' 51.5580" Long./E. 86° 22' 09.0849"
	Edited By: BTR	Date Created:	2/2003